

# TROUGH CHAIN CONVEYOR



# TROUGH CHAIN CONVEYOR



*Trough chain conveyor for heavy sodium carbonate*

## TROUGH CHAIN CONVEYOR

... - also referred as a redler - is primarily used to convey bulk materials. It is a very robust, low-maintenance conveying system designed for permanent operation. Alongside classic horizontal conveyance, rising line layouts and conveyors with bends can be realised. Further processing stages can also be simultaneously integrated such as:

- ▲ Collection/ distribution
- ▲ Screening
- ▲ Bunker discharge
- ▲ Air cooling/ water cooling
- ▲ Conveyor lengths of up to 100 m
- ▲ Conveyor capacity up to 1.500 m<sup>3</sup>/h



*Trough chain conveyor drive station*



*Distribution conveyor for sodium bicarbonate*



*Potash transport for press loading; conveyor performance approx. 150 t/h*

## THE RANGE OF CONVEYOR PRODUCTS

... extends from powder form to bulky products with an edge length of up to 150 mm. The trough chain conveyor has been used as a reliable conveyor element in the following industries for many decades:

- ▲ Soda, potash and fertiliser industry
- ▲ Cement and building materials industry
- ▲ Raw materials and biomass conveying
- ▲ Waste treatment and recycling facilities
- ▲ Power stations
- ▲ Grain and seed handling
- ▲ Chemical industry



*Oil seed conveying and distribution to silos*



*Lignite transport*

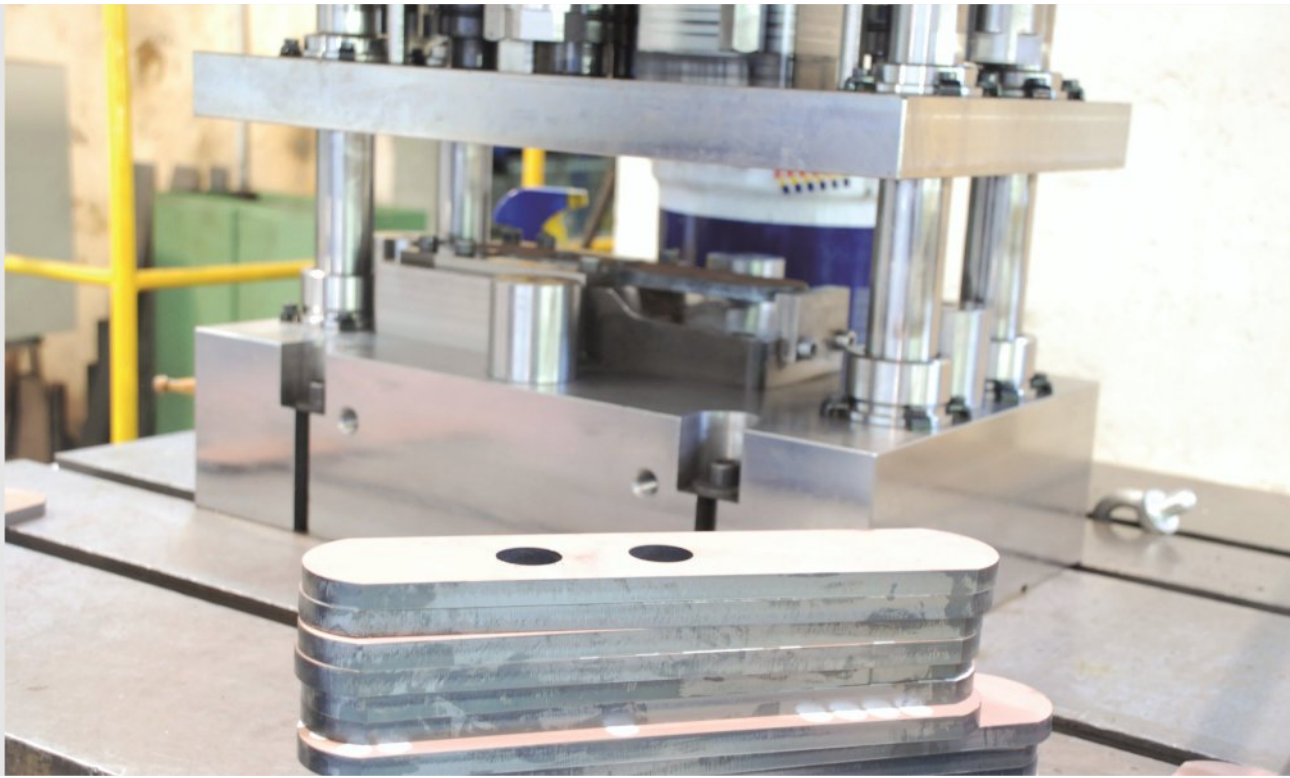

Chain link production

## QUALITY FROM OUR OWN COMPANY

The drawing element - the chain - is specified according to the requirements of the conveyed product and the results of the project-related design calculation. Full internal production guarantees a high level of flexibility and adaptation to the respective conveying task. The best tensile strength and longest service life are achieved with a conveyor chain from our own production, which has been constantly developed further and tried and tested over many years.

Alongside manufacturing new products, we offer service and repair work for existing systems, including exchange of the chain system. Professional assembly and standard monitoring systems, such as an overflow indication, bulk height indicator, rotation monitor and chain break monitoring, ensure safe, permanent operation.

- ▲ Round steel chain
- ▲ Drop-forged fork chain
- ▲ Welded fork sprocket chain
- ▲ Bush chain



Round steel chain



Drop-forged fork chain



Welded fork sprocket chain

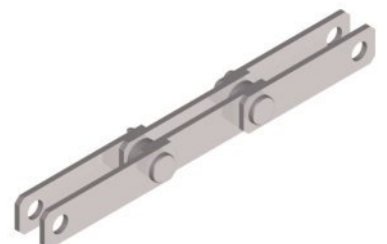

Bush chain



*Material loop and shaft with wear protection*

## WEAR PROTECTION

... assured a long-lasting use of **WUTRA** trough chain conveyors by high abrasive solids. The conveying of raw materials with different grain sizes causes a strong rubbing wear. This will be avoided with suitable methods like build-up weldings or coating of the troughs with several construction materials.

For cleaning-, wear- and material flow problems we use:

- ▲ Cast basalt
- ▲ Ceramic inlays
- ▲ Different wear materials
- ▲ Build-up welding
- ▲ Plastic plates
- ▲ Protection coatings with composite materials

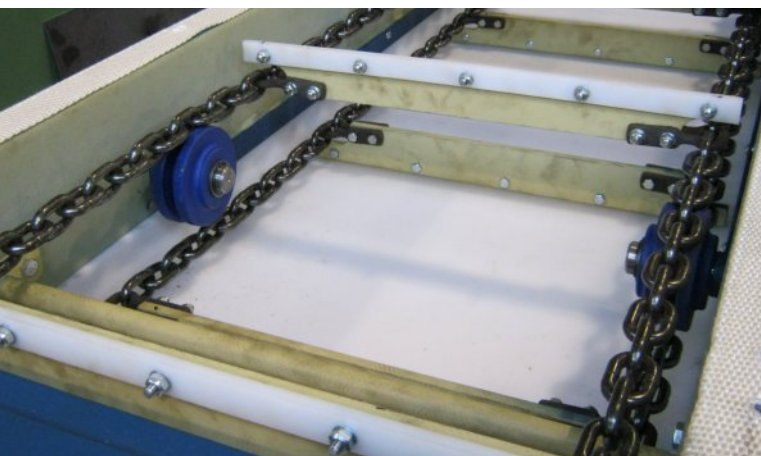

*Plastic plates lining installation*

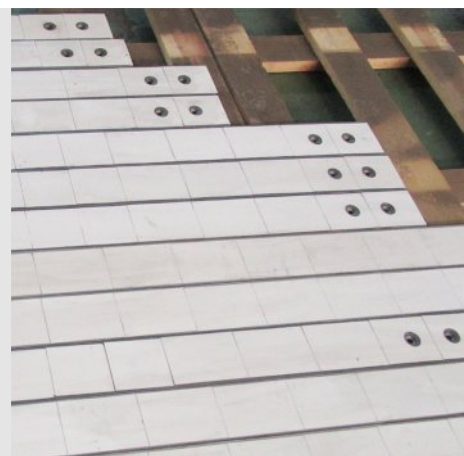

*wearing rails with ceramic layer*



*cast basalt inlay*



*Design:*

All components of the **WUTRA** delivery range were calculated and modified by our by out experienced staff. Using special design tools, developed in-house, assures a safe and proper operation for each single **WUTRA** unit.

*Certifications:*

- ▲ Quality management system ISO 9001:2015
- ▲ Certification according Atex - Directive 2014/34/EU 
- ▲ EAC certificate for customs union
- ▲ Welding certificate EN 1090
- ▲ Pressure equipment directive 2014/68/EU

*Service:*

**WUTRA** components can be installed and putted into operation worldwide. Please call our experienced technicians for regular inspections and service.

*Research and development:*

A permanent development guarantees always a high state of the art level of **WUTRA** products.

The latest scientific knowledge, based on a close cooperation with approved research institutes, will be integrated in engineering and design of our conveying equipment.

**WUTRA** components:

Screw conveyors  
Process screws  
Mixer  
Bucket elevators  
Trough chain conveyors  
Slide valves  
Way distributors  
Rotary valves  
Contract manufacturing  
Assembly/ Service

*Plant construction for:*

Soda, Potash industries  
Building materials  
Raw materials/ Minerals  
Chemistry  
Recycling  
Food  
Synthetics  
Sugar industry  
Power industry



**WUTRA** Fördertechnik GmbH

Industriestraße 4-6  
D-04808 Wurzen

Phone +49 (0) 34 25 - 81 98 - 0

Fax +49 (0) 34 25 - 81 98 - 11

mail [info@wutra.de](mailto:info@wutra.de)

[www.wutra.de](http://www.wutra.de)